

LED HEADLIGHT KIT



P/N MULTIPLE

BEFORE YOU BEGIN

Read these instructions and check to be sure all parts and tools are accounted for. Please retain these installation instructions for future reference and parts ordering information.

APPLICATION

Verify accessory fitment at www.indianmotorcycle.com.

REQUIRED SOLD SEPEARATELY

MODEL YEAR 2018 AND OLDER MOTORCYCLES ONLY

Only parts for installation of the Indian Motorcycle® LED Headlight Kit are included. For complete installation, the following additional kit is required (sold separately):

- Jumper Harness, H4 Adapter, 7 Inch Headlight, P/N 2889636

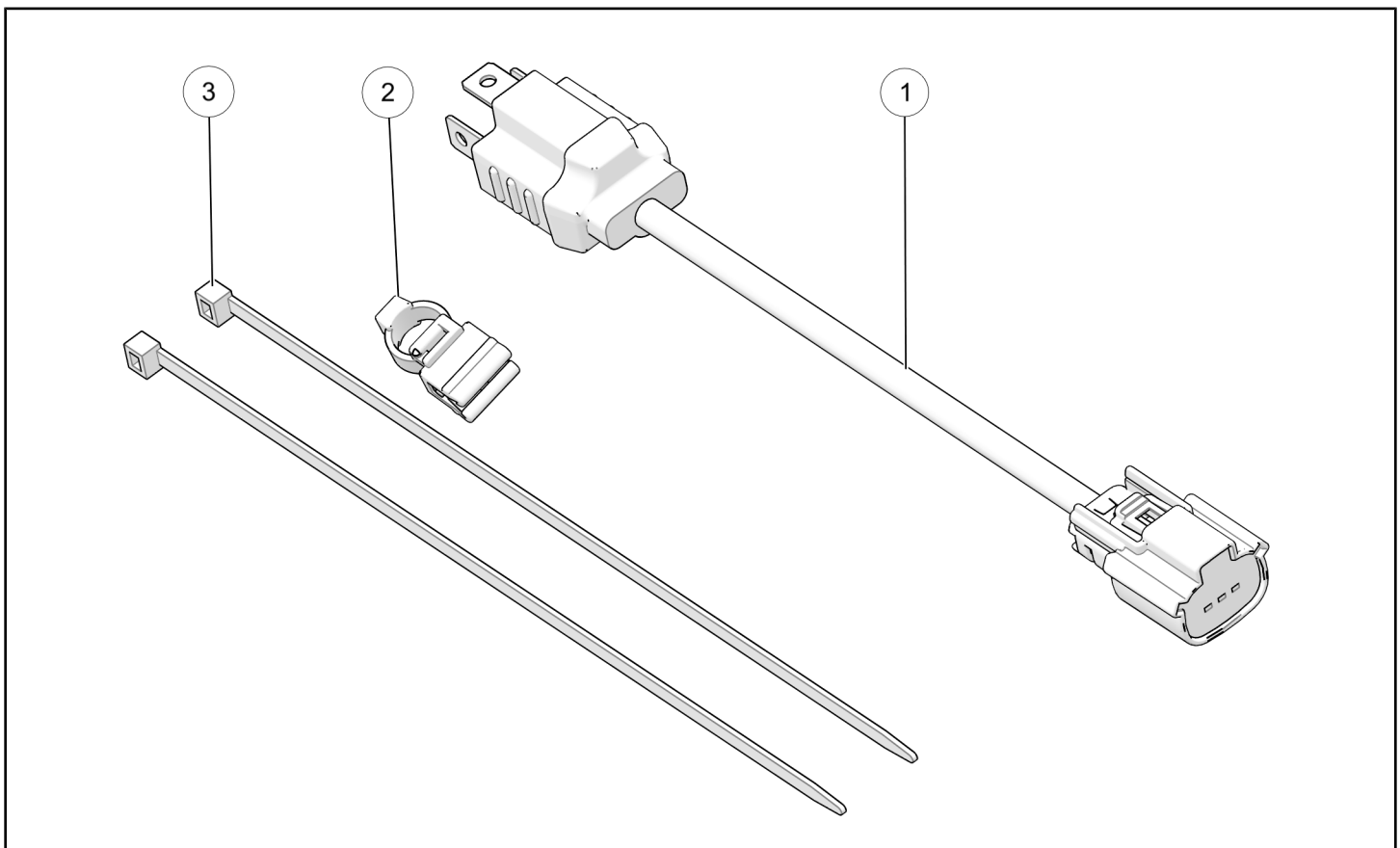

REF	QTY	PART DESCRIPTION	P/N AVAILABLE SEPARATELY
1	1	Harness, Jumper, 7 in, Headlight	2416470
2	1	Edge Clip, 1-3 mm Thickness	7082428
3	2	Cable Tie, 12-50 mm, Weather Resistant	7080138

KIT CONTENTS

Kit P/N 2884442-XXX Shown, other kits similar.

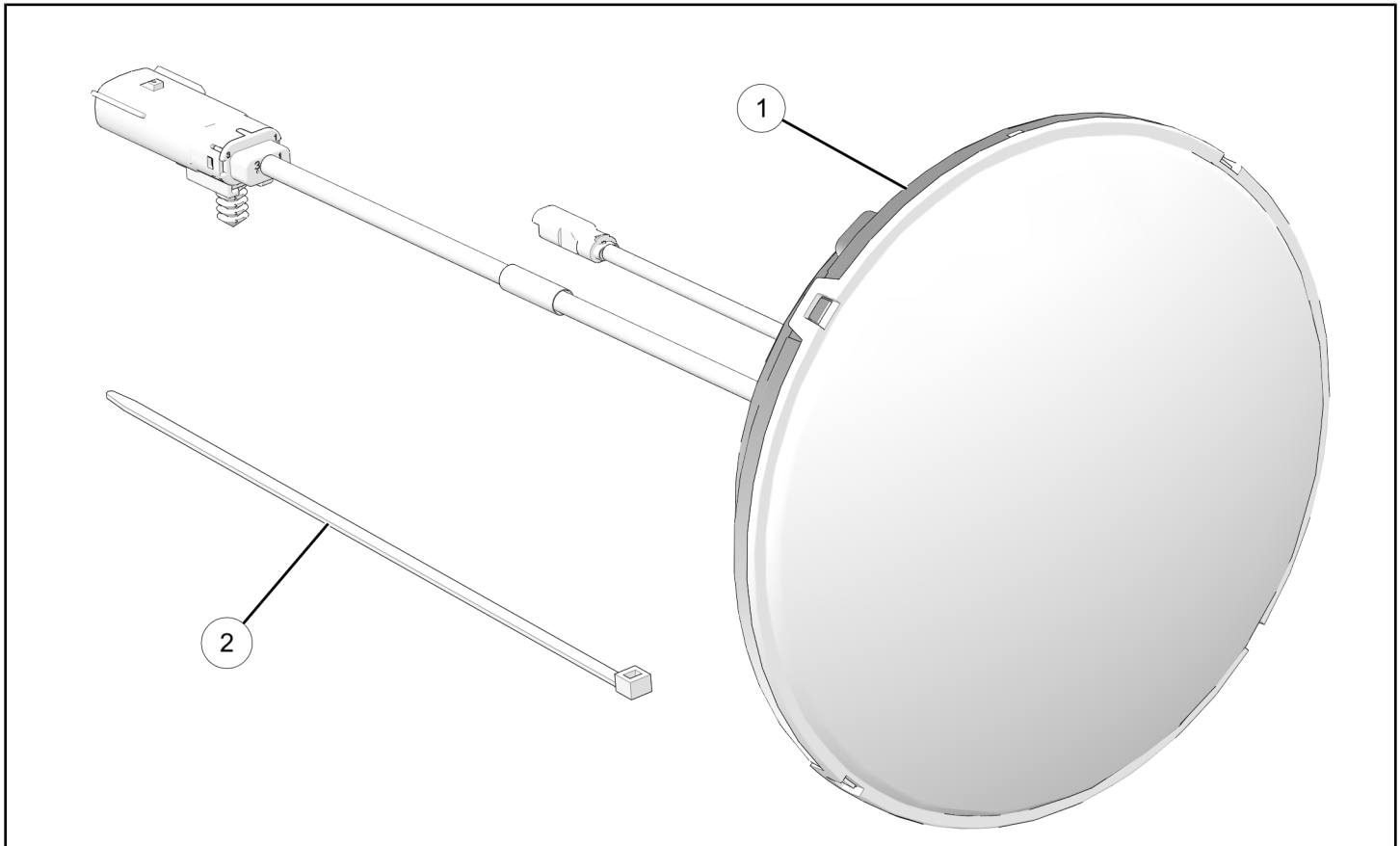

NOTICE

XXX = Indian Motorcycle® color code (For example: 266 = Black)

REF	QTY	PART DESCRIPTION	P/N AVAILABLE SEPARATELY
1	1	Assembly, Headlight, LED	N/A
2	1	Cable Tie (Kit PN 2889459-XXX; 2889460-XXX; 2884442-XXX)	7080138

TOOLS REQUIRED

- Safety Glasses
- Hex Key Set, Metric
- Pliers, Side Cutting
- Screwdriver, Phillips
- Socket Set, Hex Bit, Metric
- Socket Set, Metric
- Torque Wrench
- **Special Service Tool:**
 - Non-marring Pry Tool, P/N 5456907 (or equivalent)

IMPORTANT

Your Indian Motorcycle® LED Headlight Kit is exclusively designed for your vehicle. Please read the installation instructions thoroughly before beginning. Installation is easier if the vehicle is clean and free of debris. For your safety, and to ensure a satisfactory installation, perform all installation steps correctly in the sequence shown.

INSTALLATION INSTRUCTIONS

VEHICLE PREPARATION

GENERAL

1. Turn key or ignition switch to **OFF** position and remove key. If equipped with keyless fob, remove fob from proximity of vehicle.
2. Ensure motorcycle is parked on a flat surface, kickstand is fully extended, and vehicle is stable prior to installation.
3. Follow the headlight removal procedure appropriate to your motorcycle.

FORK MOUNTED FAIRING BIKES

HEADLIGHT BEZEL REMOVAL

Chieftain® Fairing:

- Using a small non-marring tool, pry down at the top center of headlight trim (A) to release tab, pull headlight trim (A) and rubber surround (B) from fairing and carefully set aside.

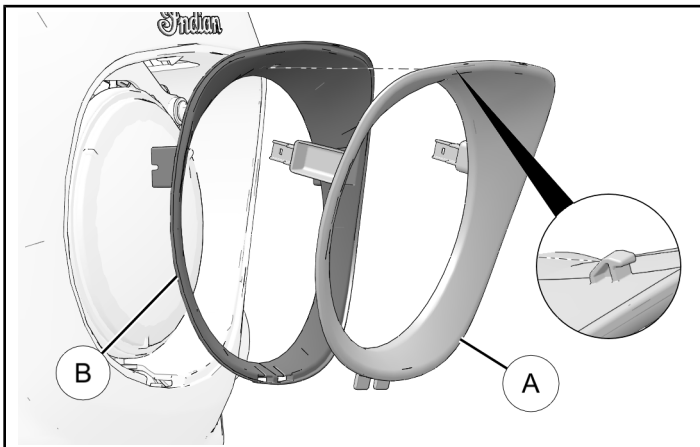

Classic Fairing:

- Remove and keep two screws (A), grip upper edge and carefully pull trim piece (B) from fairing.

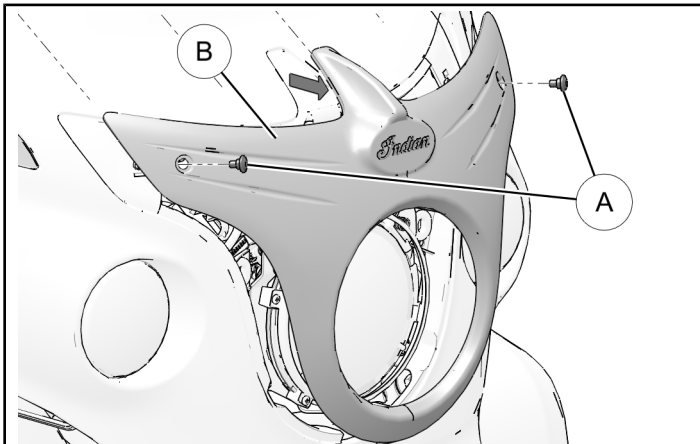

HEADLIGHT ASSEMBLY REMOVAL

1. Remove and keep four screws (C) and washers (D) from headlight assembly frame (E) and remove headlight assembly. Disconnect headlight connector (F) from headlight. Carefully set assembly aside.

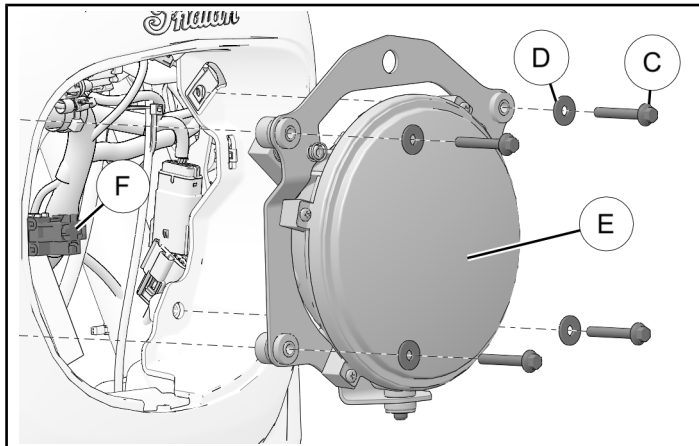

NACELLE BIKES

NACELLE REMOVAL

1. If equipped, remove windshield as per owner's manual.
2. Remove and retain two screws (A) from top of nacelle.

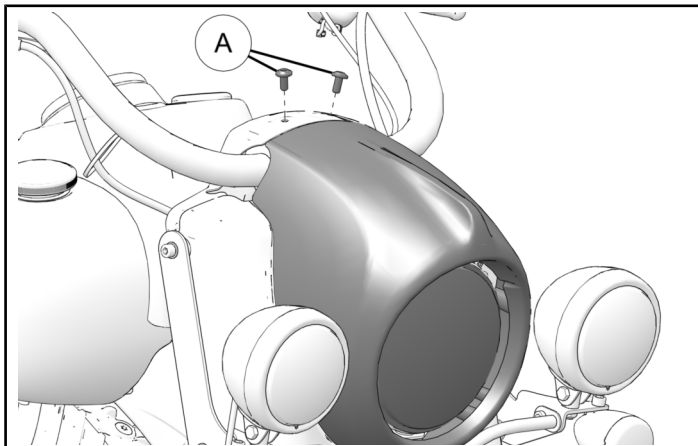

- Turn handlebars to right until locked. Remove and retain two screws and washers (B) from inside of nacelle.

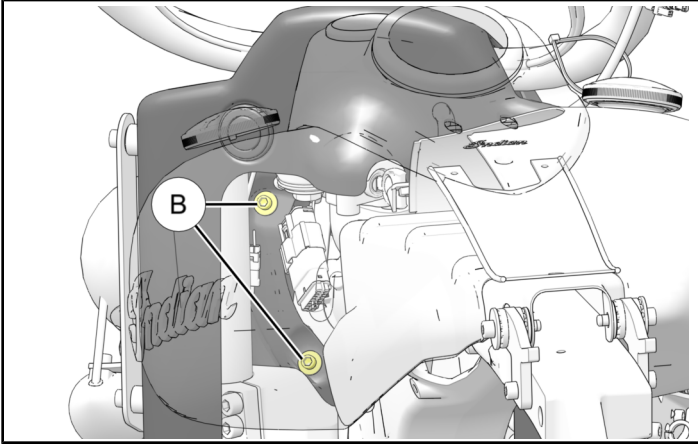

- Turn handlebars to left until locked. Remove and retain two more screws and washers (B) from inside of nacelle.

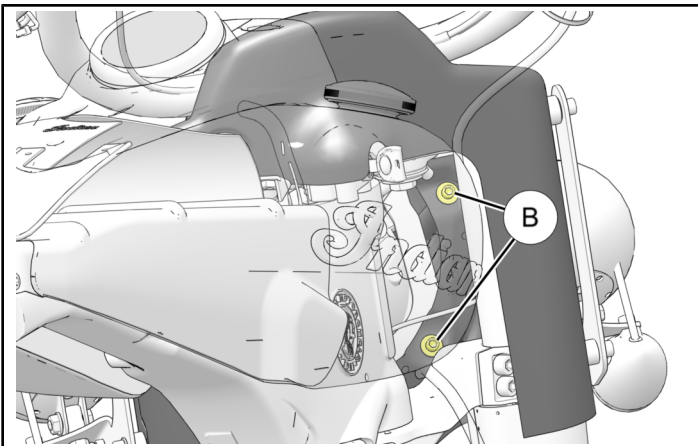

- Pull nacelle and headlight assembly (C) from bike, disconnect headlight electrical connector (D). Carefully set assembly aside.

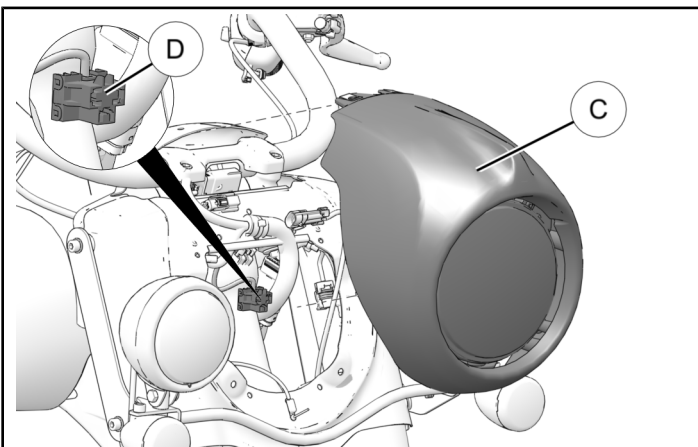

HEADLIGHT ASSEMBLY REMOVAL

- Remove and retain three headlight bracket fasteners and three washers to remove headlight assembly from nacelle.

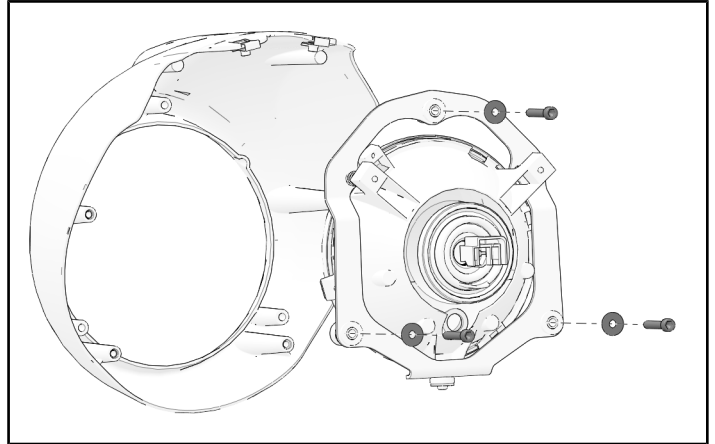

FIXED FAIRING BIKES

OUTER FAIRING REMOVAL

- Open storage doors (A) and pull out storage liners (B). Set liners aside.

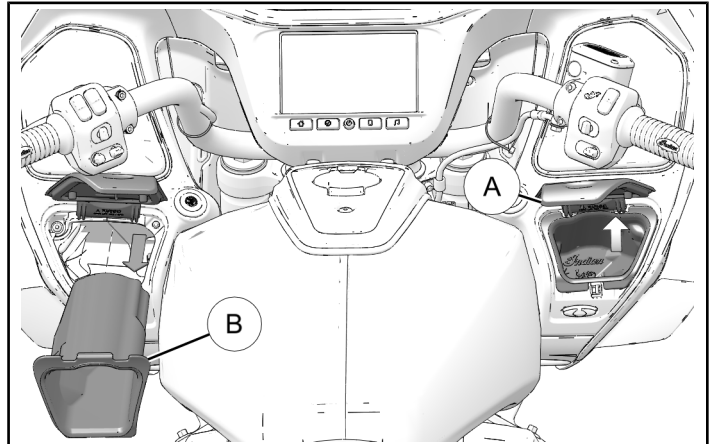

2. Carefully pry along edge with non-marring pry tool to disengage speaker grill assemblies (C).

TIP

Use Special Tool:
Non-marring Pry Tool, P/N 5456907 (or equivalent)

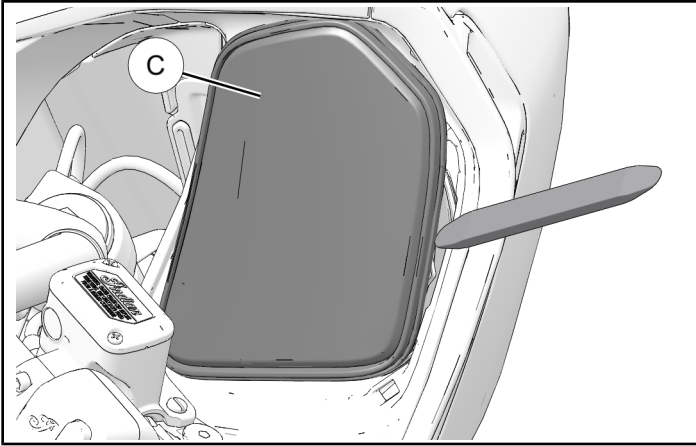

3. Gently pry along top edge of headlight bezel (D) with non-marring pry tool. Pull headlight bezel (D) down and out. Carefully set aside.

TIP

Use Special Tool:
Non-marring Pry Tool, P/N 5456907 (or equivalent)

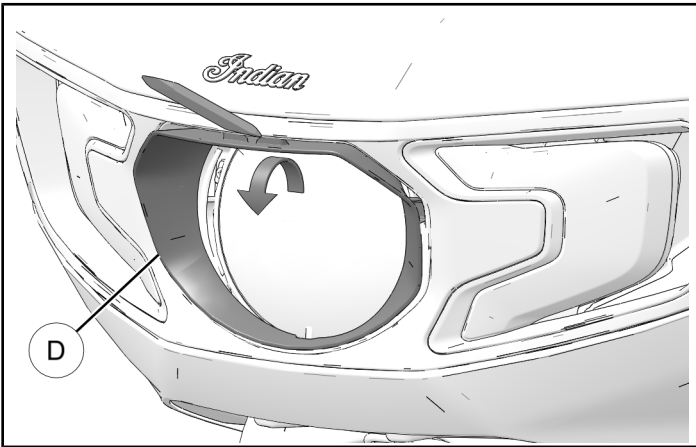

4. Remove and keep three screws (E) from around headlight bezel as shown.

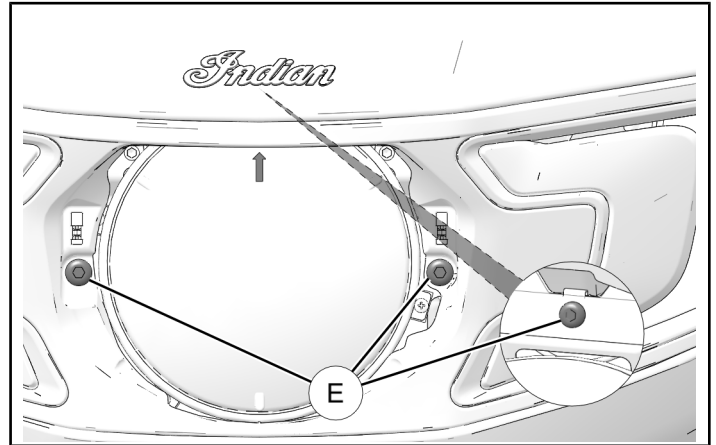

5. Remove and keep two screws (F) from top outer corner of storage openings and two screws (F) from top center of speaker openings.

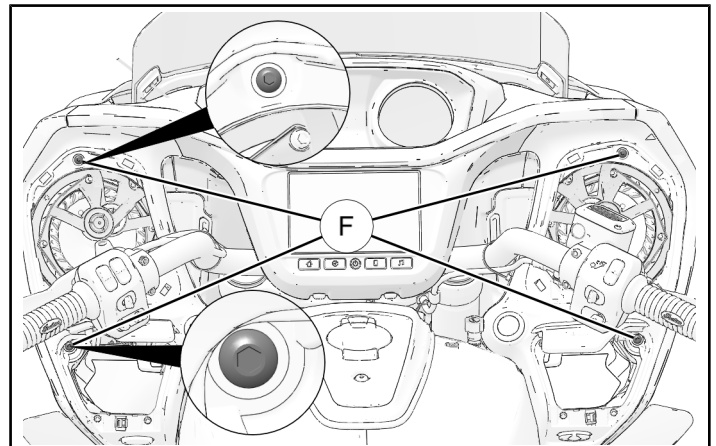

6. Remove and keep one screw ⑥ from under edge of each side of fairing as shown.

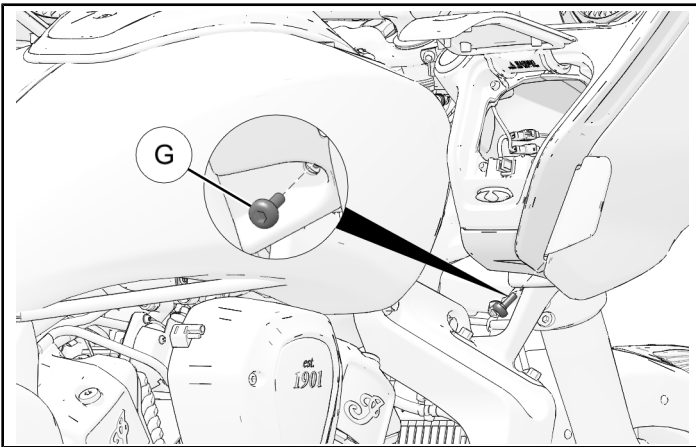
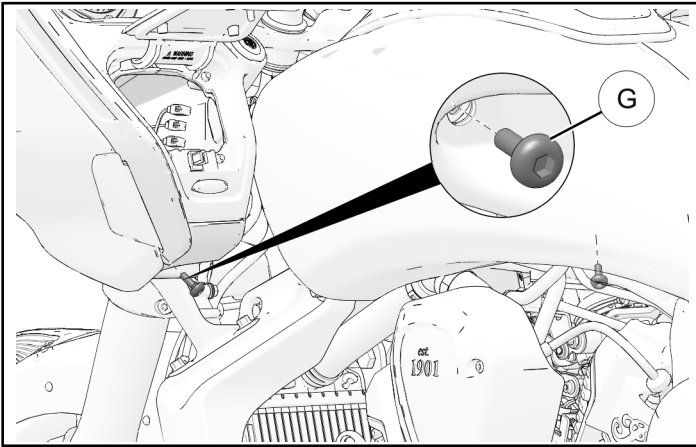

7. Pull fairing outward at top to disengage. Pull fairing out a short distance and disconnect headlight and turn signal wire connectors.

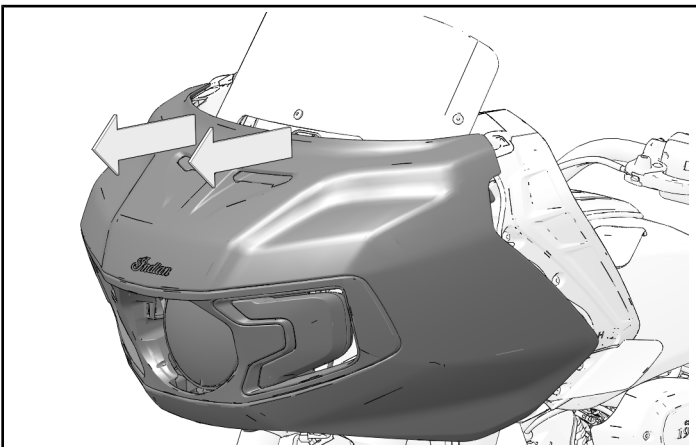

8. Disconnect connectors for headlight ⑨ and turn signals ⑩.

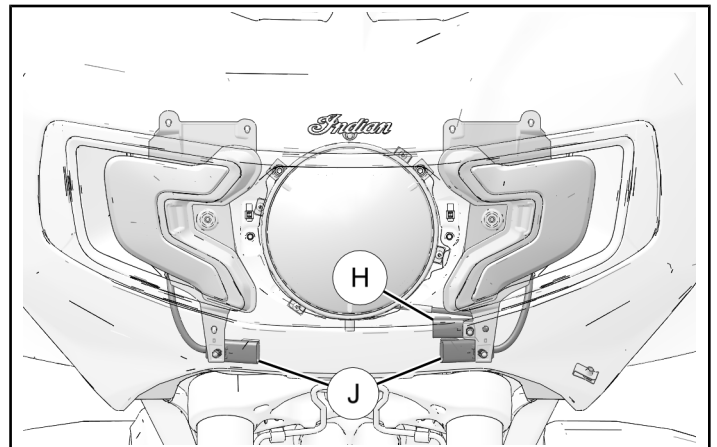

9. Carefully pull outer fairing off motorcycle and set aside.

ACCESSORY INSTALLATION

JUMPER HARNESS INSTALLATION (MODEL YEAR 2018 OR OLDER)

1. Install jumper harness ① into stock headlight connector.

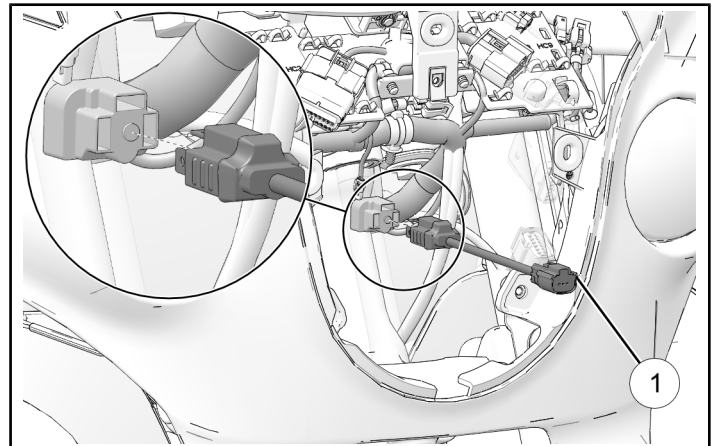

FORK MOUNTED FAIRING BIKES AND NACELLE BIKES

Fixed fairing bikes, skip ahead to

DISASSEMBLE HEADLIGHT BRACKET

1. Remove and keep four screws from headlight retaining ring.

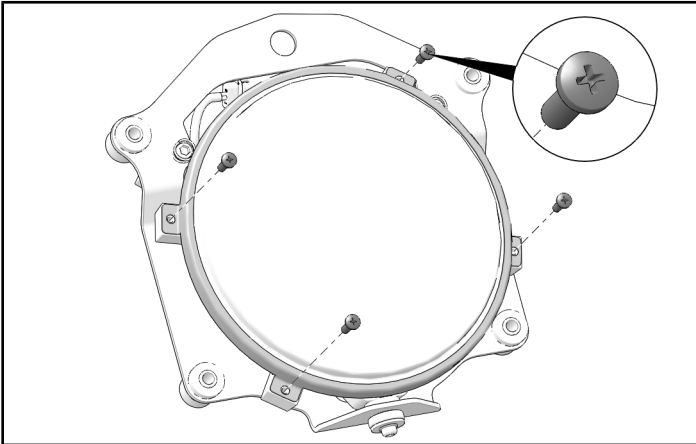

2. Remove and keep headlight retaining ring. Remove and discard stock headlight.

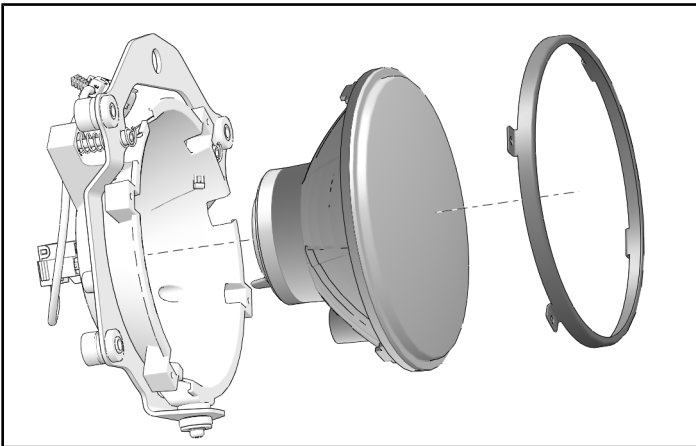

ASSEMBLE HEADLIGHT BRACKET

1. Install headlight assembly ① into headlight bracket and set retaining ring back into place.

TIP

When the headlight is oriented properly, it will nest into the plastic carrier.

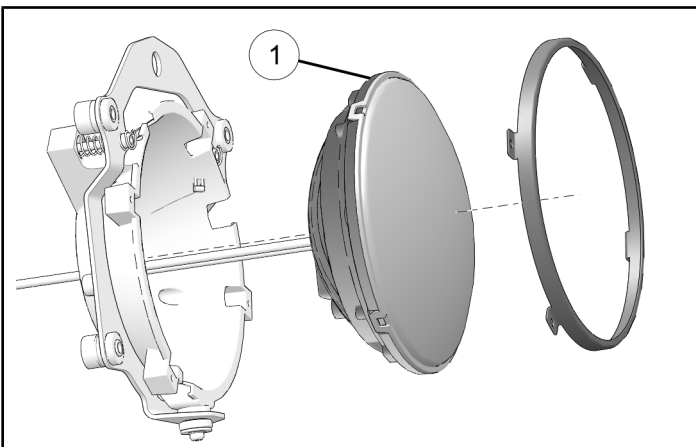

2. Secure retaining ring in place with four kept screws. Torque screws to specification.

TORQUE

Headlight Retaining Ring Screw:
12 in-lbs (1.5 N·m)

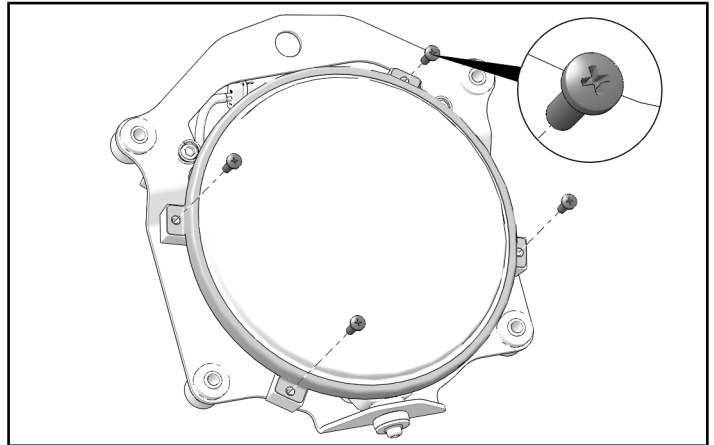

FAIRING BIKE HEADLIGHT BRACKET INSTALLATION

INSTALL HEADLIGHT BRACKET

1. Connect headlight connector ⑥ to headlight. If equipped, plug in accent light lead to wire connector (accent light wire found on 2017 and newer models without lit fender headress). Install headlight into place. Attach headlight assembly frame ⑤ with four retained screws ③ and washers ④. Torque screws to specification.

TORQUE

Headlight Bracket Fasteners ③:
75 in-lbs (8.5 N·m)

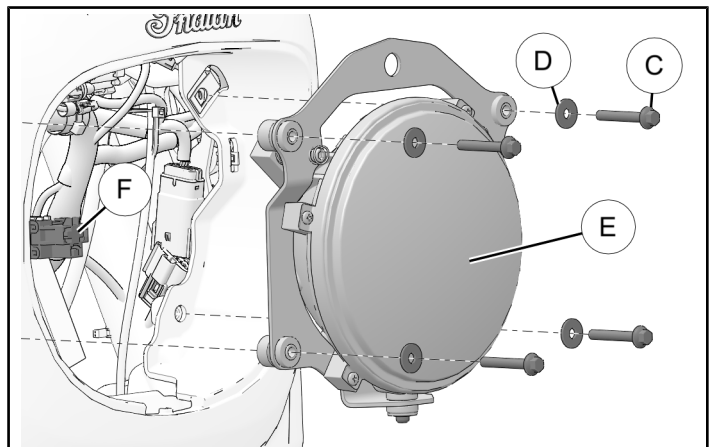

NACELLE BIKE HEADLIGHT INSTALLATION

HEADLIGHT ASSEMBLY INSTALLATION

1. Install headlight assembly within nacelle with three headlight bracket fasteners and three washers.

TORQUE

Headlight Bracket Fasteners:
84 in-lbs (9.5 N·m)

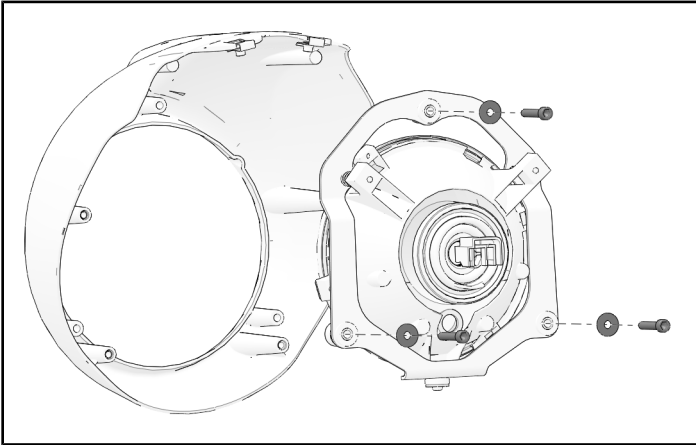

NACELLE INSTALLATION

1. Connect headlight electrical connector ① into headlight. If equipped, plug in accent light lead to wire connector (accent light wire found on 2019 and newer models without lit fender headress). Install nacelle assembly ② into place.

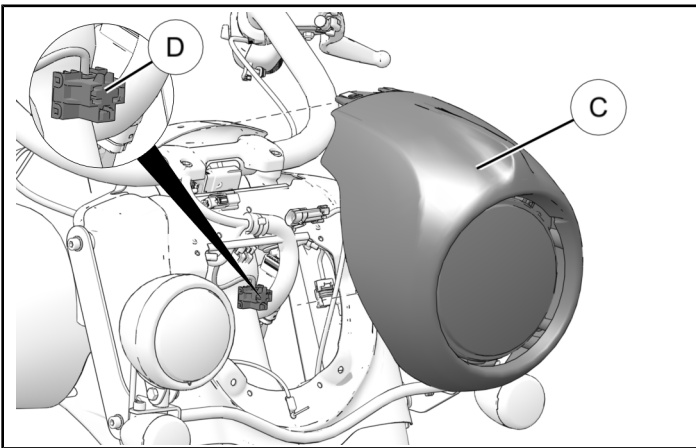

2. Turn handlebars to left until locked. Loosely install two retained screws and washers ③. **DO NOT tighten screws at this time.**

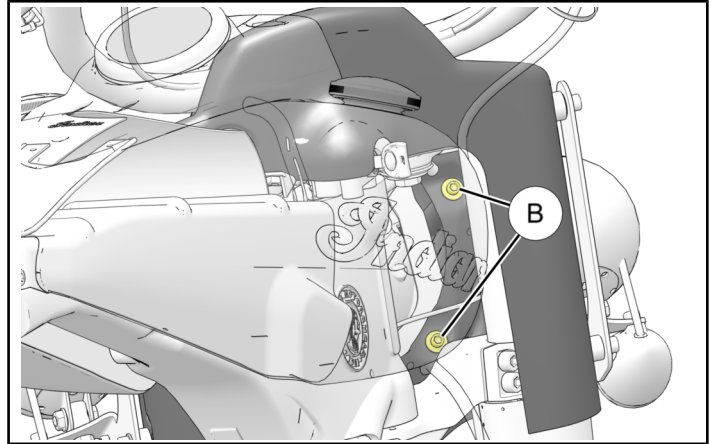

3. Turn handlebars to right until locked. Loosely install two retained screws and washers ③. **DO NOT tighten screws at this time.**

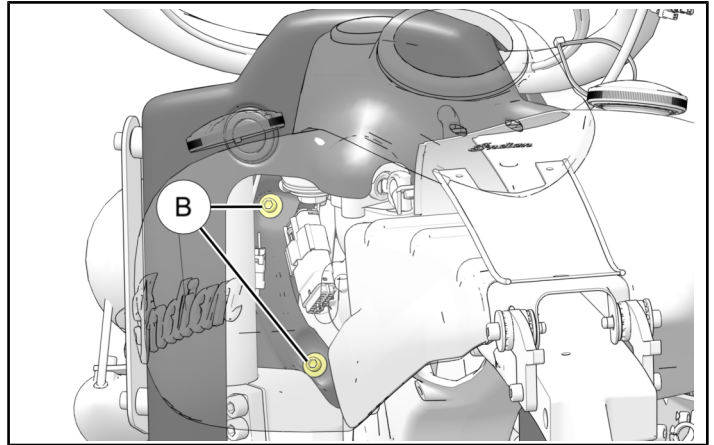

4. Loosely install two retained screws ④ into top of nacelle.

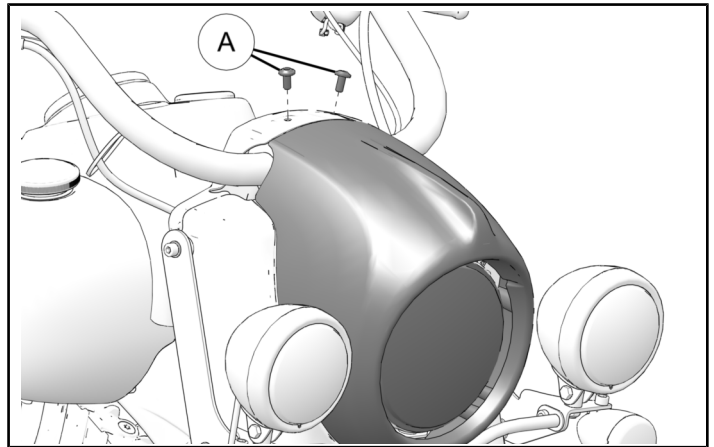

5. Ensure all wires and cables are properly tucked inside nacelle. Ensure nacelle is properly aligned and torque screws to specification.

TORQUE

Nacelle top screws (A):
36 in-lbs (4 N·m)

TORQUE

Nacelle inner screws (B):
75 in-lbs (8 N·m)

FIXED FAIRING BIKES

HEADLIGHT REMOVAL

1. Remove and keep two headlight bracket fasteners.

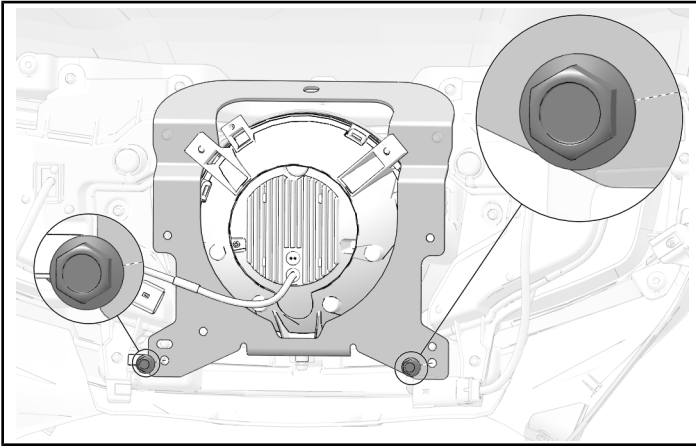

2. Remove headlight assembly from outer fairing.

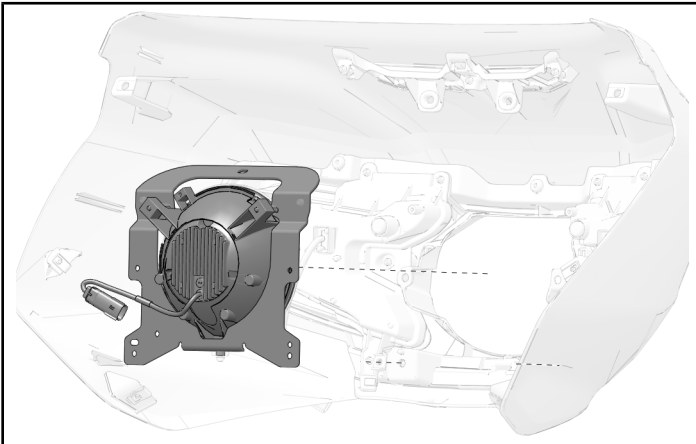

3. Remove and keep four headlight retaining ring fasteners.

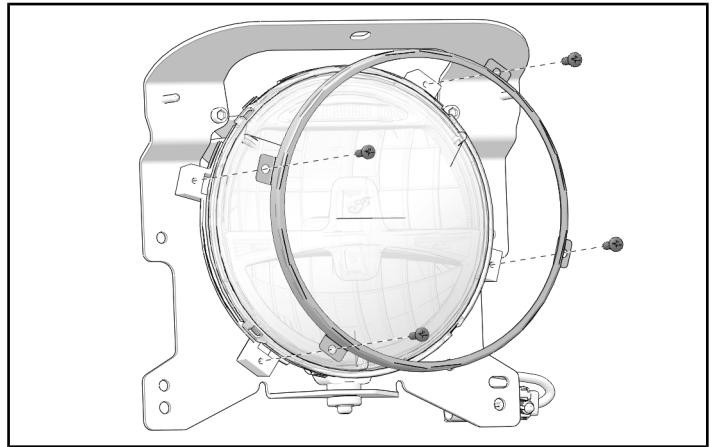

4. Remove lower headlight fastener and remove headlight from bracket.

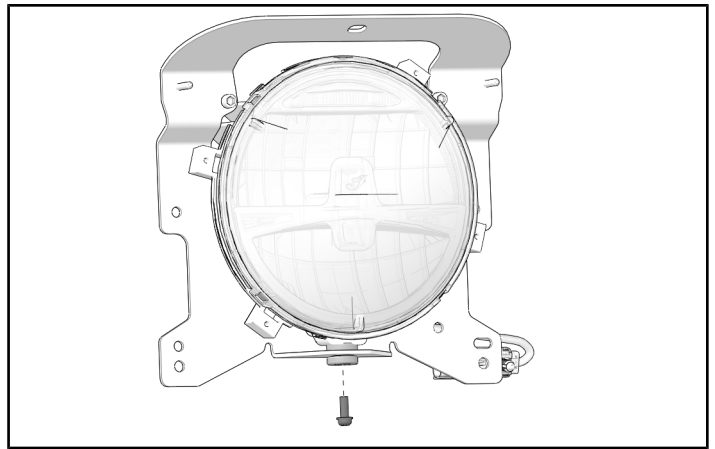

ASSEMBLE HEADLIGHT BRACKET

1. Install new headlight ① into bracket and attach with lower headlight fastener. Torque fastener to specification.

TORQUE

Lower Headlight Fastener:
12 in-lbs (1 N·m)

TIP

When the headlight is oriented properly, it will nest into the plastic carrier.

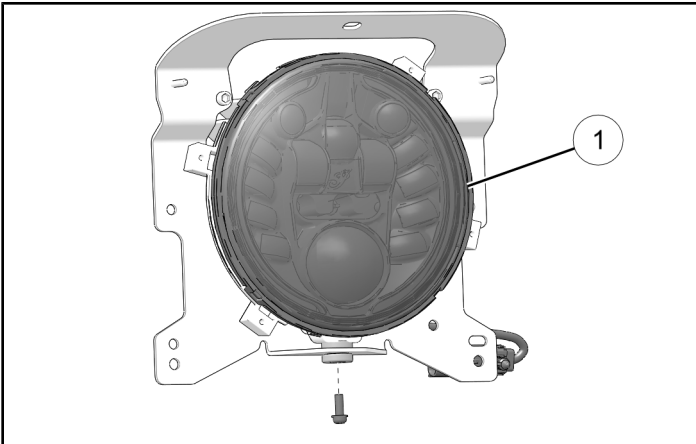

2. Install headlight retaining ring and attach with four headlight retaining ring fasteners. Torque fasteners to specification.

TORQUE

Headlight Retaining Ring Fasteners:
12 in-lbs (1 N·m)

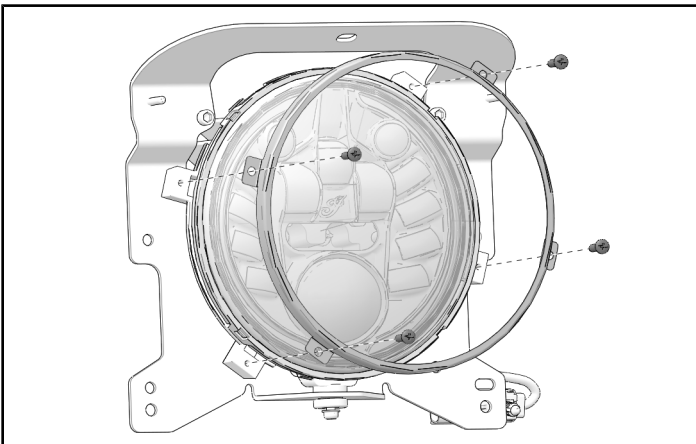

3. Install headlight assembly into outer fairing.

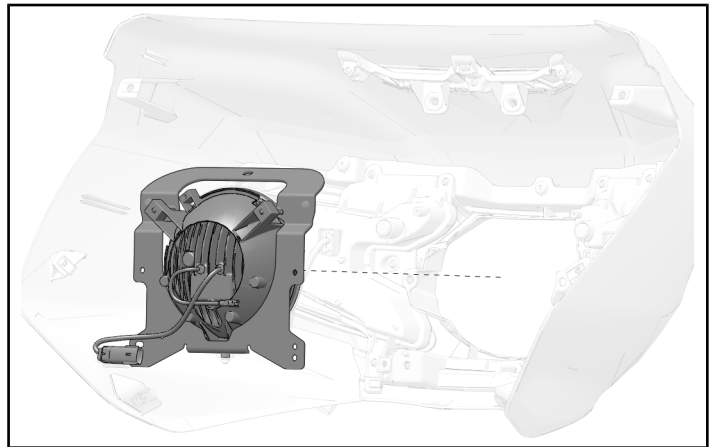

4. Attach headlight assembly with two headlight bracket fasteners. Torque fasteners to specification.

TORQUE

Headlight Bracket Fasteners:
36 in-lbs (4 N·m)

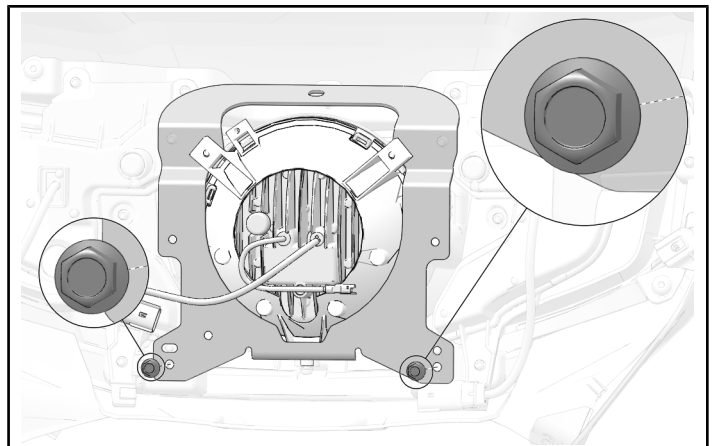

OUTER FAIRING INSTALLATION

1. Lubricate two grommets on inside of fairing.

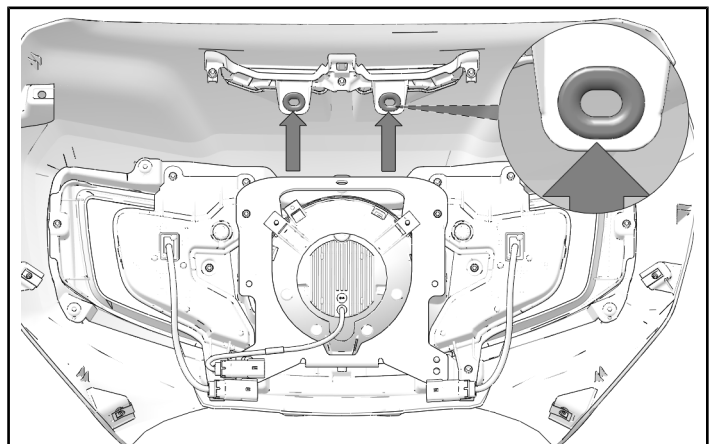

2. Set outer fairing in place and connect turn signal **J** and headlight **H** wire connectors.

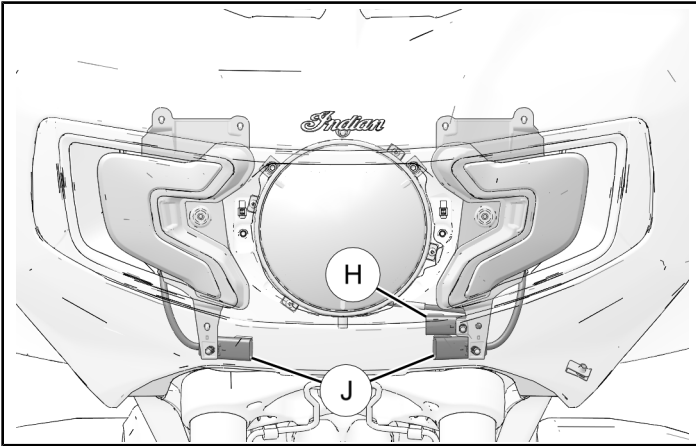

3. Press fairing into place and at top edge to engage locating pins.

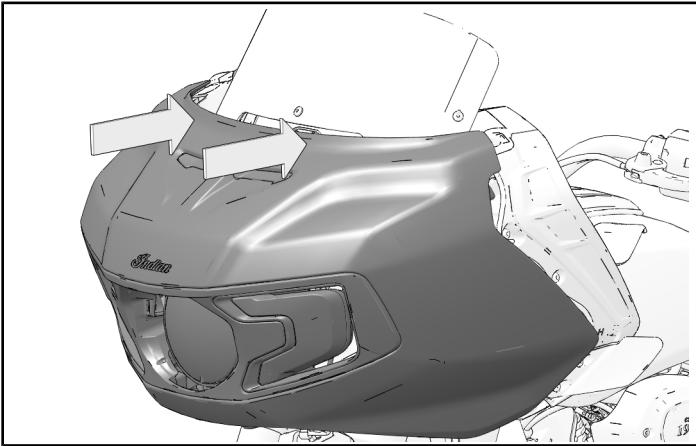

4. Loosely install one screw **G** into hole under edge of each side of fairing as shown.

DO NOT torque fasteners at this time.

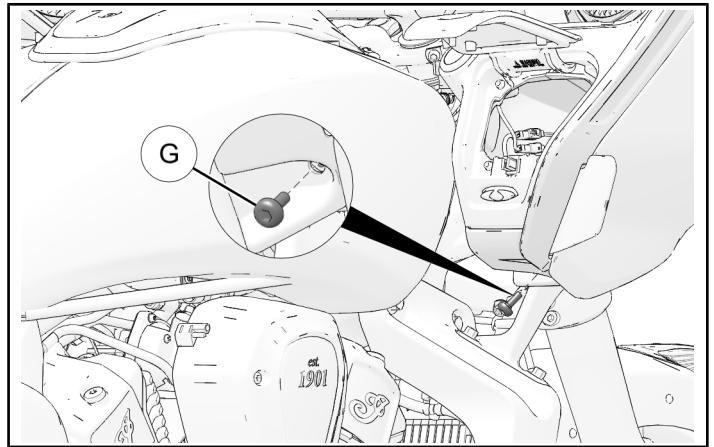
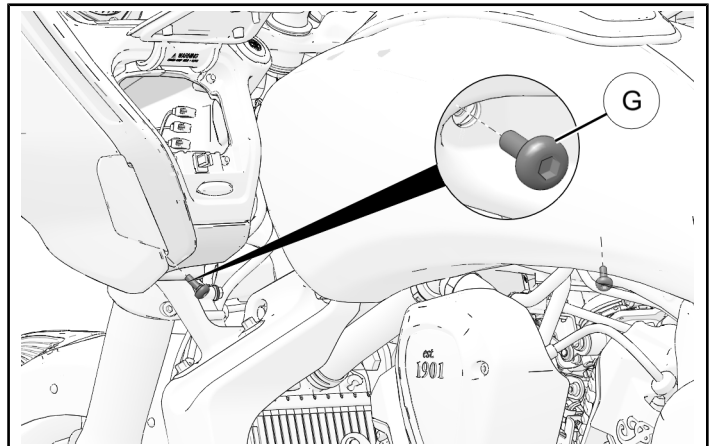

5. Loosely install two screws **F** into top outer corner of storage openings and two screws **F** into top center of speaker openings.

DO NOT torque fasteners at this time.

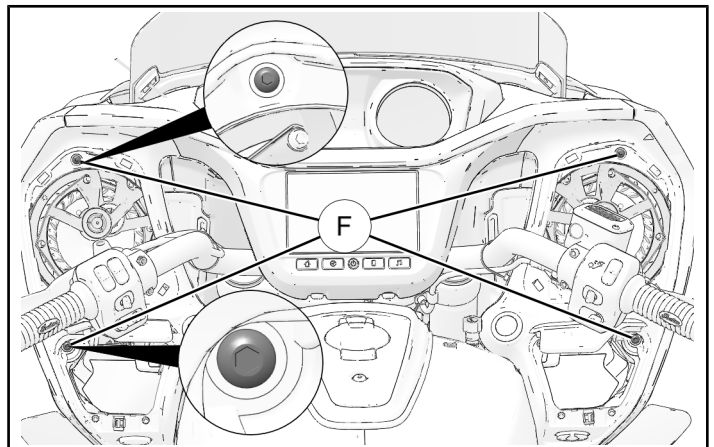

6. Loosely install three screws (E) around headlight bezel as shown.

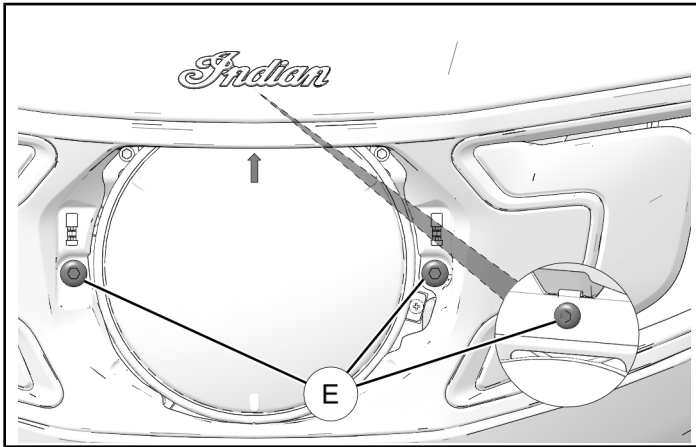

7. Torque all outer fairing screws to specification.

TORQUE

Outer Fairing Screws (E), (F), (G):
36 in-lbs (4 N·m)

8. Carefully reinstall headlight bezel (D) into outer fairing opening starting with bottom tab. Push down on bezel (or use non-marring tool as shown) to insert upper tabs without damaging finish.

TIP

Use Special Tool:
 Non-marring Pry Tool, P/N 5456907 (or equivalent)

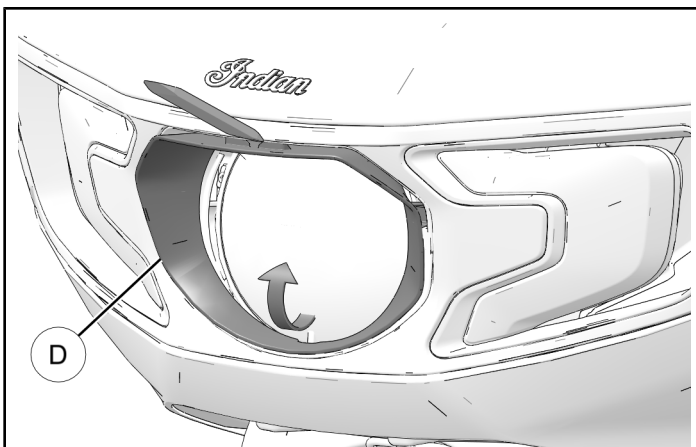

9. Reinstall fairing speaker grills (C).
 10. Reinsert storage liners (B).

LED HEADLIGHT AIM INSPECTION AND ADJUSTMENT

HEADLIGHT AIM INSPECTION PROCEDURE

IMPORTANT

Adjust headlight aim when there is a change in load (rider, cargo, accessories, etc.) and /or after suspension adjustment.

Follow all steps below to ensure accurate aim inspection.

1. Check and adjust the tire pressure to specification.
2. Verify suspension ride height (preload) is set to specification.
3. Move the motorcycle to a clear area with a level floor and dim lighting, and place it so the top front edge of the headlight housing is 32 ft10 in (10 m) from the wall.
4. With the rider and passenger (if applicable) on board, bring the motorcycle to a fully upright position. Center the handlebars in a straight ahead position.
5. Start the engine and switch the headlight on in LOW mode:
6. Compare the position of headlight beam on the wall to the illustration below and adjust if necessary.

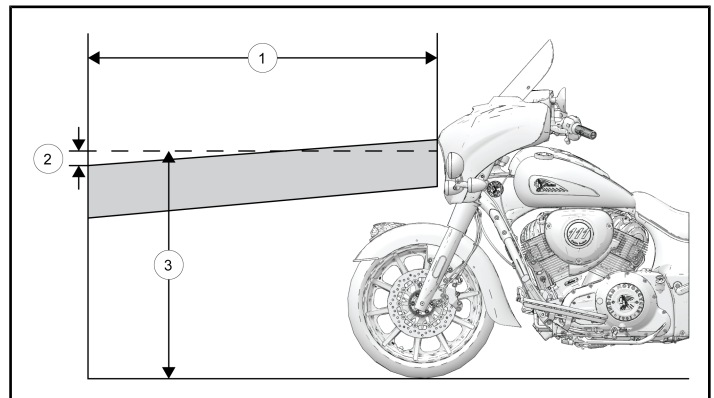

With the headlight switched to LOW beam, the top of the highest intensity (appears as a diamond shape for standard LED and a horizon line for adaptive LED) should be 4 in (10 cm) below the height of the headlight bulb (3) when centered straight ahead at 32 ft10 in (10 m).

LOCATION	MEASUREMENT
①	32 ft10 in (10 m)
②	4 in (10 cm)
③	Headlight Center

HEADLIGHT AIM ADJUSTMENT

The headlamp adjustment screws are located inside the headlamp housing. (Fairing bike shown, screws are located in same position on all bikes.)

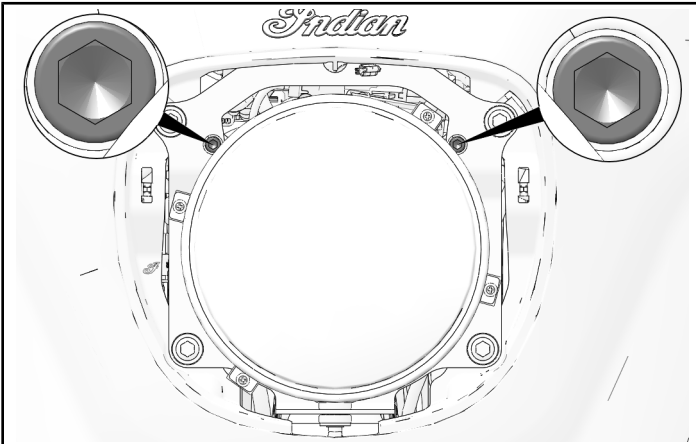

1. To adjust the headlamp vertically, tighten both top adjustment screws equally to adjust the beam downward. Loosen both screws equally to adjust the beam upward.
2. To adjust the headlamp horizontally, loosen the left side screw to adjust the beam to the left. Loosen the right side screw to adjust the beam to the right.

TIP

Use the high beam to help center horizontally.

VEHICLE REASSEMBLY

FAIRING BIKE HEADLIGHT BEZEL INSTALLATION

INSTALL HEADLIGHT BEZEL

Chieftain® Fairing:

- Install rubber surround (B) and headlight trim (A) into fairing and carefully press into place.

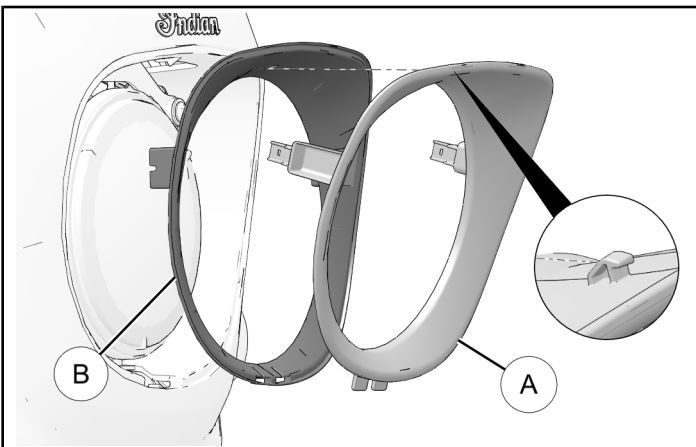

Classic Fairing:

- Install trim piece (B) into fairing and attach with two retained screws (A). Torque screws to specification.

TORQUE

Bezel Fasteners (A):
36 in-lbs (4 N·m)

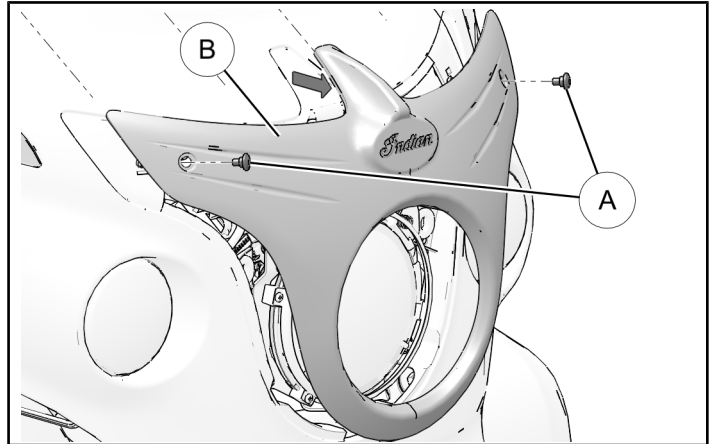

OPERATION

ADAPTIVE HEADLIGHT OPERATION

- Adaptive headlight features activate automatically with steering and speed inputs.
 - Adaptive headlight elements will not fully activate when bike is parked.

- Dedicated high beam adaptive lights only function when high beam is activated.
- Low beam adaptive lights will continue to function with high beams.

INSTRUCTION FEEDBACK FORM

A feedback form has been created for the installer to provide any comments, questions or concerns about the installation instructions. The form is viewable on mobile devices by scanning the QR code or by clicking [HERE](#) if viewing on a PC.

